

1



PRINTIND
说明书

2



快速入门操作

3

扫码下载PrintInd

按照示意图往左侧方向掰, 墨盒会松开, 随后向上拔出墨盒

请按照箭头的方向安装墨盒, 并用力扣紧墨盒, 防止接触不良

扫码观看操作教程

扫码观看视频教程

添加设备

正在搜索设备...

ESP_SPP_SERVER A0A3B557719A 添加

点击“添加”蓝牙信号, 设备自动完成连接

指示灯 打印/暂停

按一下机器的“功能键”指示灯会闪烁, 代表正在打印状态(如需暂停按一下功能键即可)

在打印状态下, 向右滑动即可打印(原理: 依靠底部的小滚轮接触表面滑动后感应出墨)

选择需要打印的图片, 点击“打印”传图至100%

拔出“ON”开机

打开APP点击“未连接”选择: PrintInd机型

光滑表面打印时, 应将滚轮的另一头抬起来一些, 再滑动打印, 或利用辅助尺垫起来打印避免蹭到刚打印的地方

打印定位的方法: 向右滑动一个机身宽度的距离后, 开始打印图案(每次打印前预留一个机身宽度的距离, 就可以很好地打印在需要的位置上)

拆取墨盒的方法: 在墨盒卡扣左右箭头位置同时向内挤压, 同时向外拉墨盒可取出墨盒

墨盒保存/维护方法

4

打印小技巧



光滑表面打印时, 应将滚轮的另一头抬起来一些, 再滑动打印, 或利用辅助尺垫起来打印避免蹭到刚打印的地方

打印定位的方法: 向右滑动一个机身宽度的距离后, 开始打印图案(每次打印前预留一个机身宽度的距离, 就可以很好地打印在需要的位置上)

拆取墨盒的方法: 在墨盒卡扣左右箭头位置同时向内挤压, 同时向外拉墨盒可取出墨盒

注意事项! 使用前请认真阅读:

- 1.打印技巧: 因为油墨是速干型的, 打印前先在废纸上测试打印效果, 打印没问题再往物品上打印, 避免打坏的情况和无法擦掉的情况。
- 2.墨盒保存: 因油性墨水有速干的特性, 加上喷头芯片十分精密, 应避免长时间裸露在空气中造成风干的现象, 使用完毕后应立即放回墨夹中密封保存。
- 3.墨盒维护: 如出现打印断墨的情况, 请将墨盒取下, 用纸巾折叠后包住墨盒喷头, 用力甩几下, 再按压几秒, 确保有按出墨后擦拭干净再装上使用即可。

参数

| | | | |
|------|-----------------------|------|----------|
| 名称 | PrintInd | 无线连接 | 蓝牙 4.2 |
| 外形尺寸 | 5.2cm x 4.3cm x 9.5cm | 最大功率 | 10W |
| 产品重量 | 160.5g (含墨盒) | 输入参数 | DC/5V=2A |

保修政策

- 1.本产品将会提供终身免费升级服务;
- 2.若产品本身有材料或工艺缺陷, 请与当地经销商联系进行维修或更换;
- 3.本产品提供整机保修一年服务。保修期自客户收到产品之日开始计算, 在保修期内本产品出现性能故障情况, 可免费享受维修服务。

非保修条例

- 1.未经授权维修、误用、碰撞、疏忽、滥用、进液、事故、改动、不正确的使用非本产品配件, 撕毁、涂改标贴、防伪标记;
- 2.已超过三包有效期;
- 3.因不可抗力造成的损坏;
- 4.因人力原因导致本产品及配件产生性能故障。

产品中有害物质的名称及含量

| 有害物质 | 部件名称 | | | | | | |
|--------|------|-----|-------|-----|-----|----|----|
| | 塑胶外壳 | 电路板 | 连接板零件 | 连接轴 | 五金件 | 墨盒 | 螺丝 |
| 铅(Pb) | ○ | ○ | ○ | ○ | ○ | ○ | ○ |
| 镉(Cd) | ○ | ○ | ○ | ○ | ○ | ○ | ○ |
| 汞(Hg) | ○ | ○ | ○ | ○ | ○ | ○ | ○ |
| 六价铬 | ○ | ○ | ○ | ○ | ○ | ○ | ○ |
| 多环芳烃 | ○ | ○ | ○ | ○ | ○ | ○ | ○ |
| 邻苯二甲酸酯 | ○ | ○ | ○ | ○ | ○ | ○ | ○ |

◎ 表示该有害物质在该部件所有均质材料中含量均在GB/T26575-2011规定的限量要求下。
* 表示该有害物质在该部件的某一均质材料中含量超出GB/T26575-2011规定的限量要求下。

6



PRINTIND
Quick Start Guide

7



Quick Start Guide

8

扫码安装PrintInd APP

Move to the left according to the schematic diagram, the ink cartridge will release and then pull it out upwards

Please install the ink cartridge in the direction of the arrow and firmly fasten it to prevent poor contact

扫码观看操作教程

扫码观看视频教程

添加设备

Searching For Devices...

ESP_SPP_SERVER A0A3B55771D6 ADD

Click "Add" Bluetooth signal, the device automatically completes the connection

Indicator light Print/Pause

Pressing the "function button" indicator light of the machine will flash to indicate that printing is in progress (if you need to pause pressing the function button once)

选择需要打印的图片, 点击“打印”, 并上传材料至100%

Move power button switch to turn-on

Open the app and click 'Unconnected' to select: PrintInd device

When printing on a smooth surface, the other end of the roller should be lifted up a bit, and then slide or use an auxiliary ruler to pad it to avoid rubbing against the newly printed area.

Method of printing positioning: Hold the machine and slide it to the right for a distance equal to the width of one machine body, the print will start to appear by reserving a distance equal to the width of machine body before each printing, it can be printed well in the required position!

Method for removing ink cartridges: Press on both sides to pull out the cartridge.

9

Good method of operation

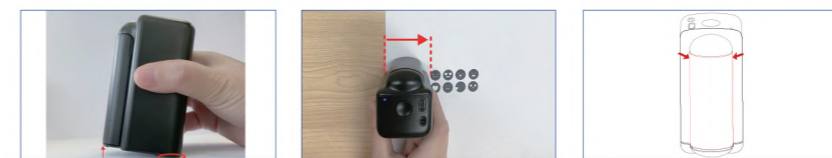

When printing on a smooth surface, the other end of the roller should be lifted up a bit, and then slide or use an auxiliary ruler to pad it to avoid rubbing against the newly printed area.

Method of printing positioning: Hold the machine and slide it to the right for a distance equal to the width of one machine body, the print will start to appear by reserving a distance equal to the width of machine body before each printing, it can be printed well in the required position!

Method for removing ink cartridges: Press on both sides to pull out the cartridge.

Precautions! Please read carefully before use

- 1.Operation method: Because the ink is a fast drying type, please test the printing effect on the paper before printing. If there is no problem with printing, then print on the item to avoid damage and inability to erase it
- 2.Ink cartridge storage: Due to the fast drying characteristics of oily ink and the precision of the nozzle chip, it is necessary to avoid exposing the nozzle to the air for a long time, which may cause the ink cartridge nozzle to air dry. After use, it should be immediately placed back in the ink holder and sealed for storage.
- 3.Ink cartridge maintenance: If there is a situation where ink is not flowing or white stripes appear during printing, please remove the ink cartridge. Fold a tissue and wrap it around the print head of the cartridge. Give it a few firm shakes and then press down for a few seconds to ensure that ink is released. Clean the print head thoroughly with a tissue before reinstalling and using it again.

Parameters

| | | | |
|--------------|-----------------------------|------------------|---------------|
| Product Name | PrintInd | Connectivity | Bluetooth 4.2 |
| Dimensions | 5.2cm x 4.3cm x 9.5cm | Operation Power | 10W |
| Net Weight | 160.5g (cartridge included) | Input Parameters | DC/5V=2A |

Warranty Terms

- 1.Manufacturer will offer free software upgrade service.
- 2.Manufacturing defects in materials or workmanship of the product, please contact local dealer for repair or replacement.
- 3.Manufacturer will provide a 12 month warranty, The limited warranty starts from the day the customer receives the product. During the warranty period, a free repair or replacement service shall be provided in warranty terms.

Warranty Exclusion

- 1.Violations against warranty, including but not limited to customer induced damage, such as self-repairs, exposure to water, damage caused by misuse alternation, failure to comply with product manual, and so on.
- 2.Exceeding warranty period.
- 3.Damage caused by force majeure.
- 4.Performance and accessories failure caused by human factors.

10